

# MARILEE WOOD MEMORIAL GARDEN

0.2 Acres  
Wimberley, Texas 78676

11.30.2023  
100% PERMIT SET

## SHEET INDEX

Sheet No. Sheet Title

LANDSCAPE DRAWINGS	
Cover	General Notes
L0.01	Site Materials Plan
L1.02	Site Layout Plan
L7.01	Site Details
L7.02	Site Details
L7.03	Site Details
L7.04	Site Details
L7.05	Site Details
L8.01	Planting Plan

## Signatures

Client Name/ Title	_____	Date	_____
Client Name/ Title	_____	Date	_____
Client Name/ Title	_____	Date	_____
Client Name/ Title	_____	Date	_____
Client Name/ Title	_____	Date	_____
Client Name/ Title	_____	Date	_____

Location Map



**CLIENT:**  
Friends of Blue Hole

PO Box 1601  
Wimberley, TX 78676  
Email: info@friendsofbluehole.org  
Contact: Andrew Weber

**LANDSCAPE ARCHITECT:**  
Lionheart Places

1023 Springdale Road  
Building 6, Suite C  
Austin, TX 78721  
Tel: 512.520.4458  
Contact: Steven Spears

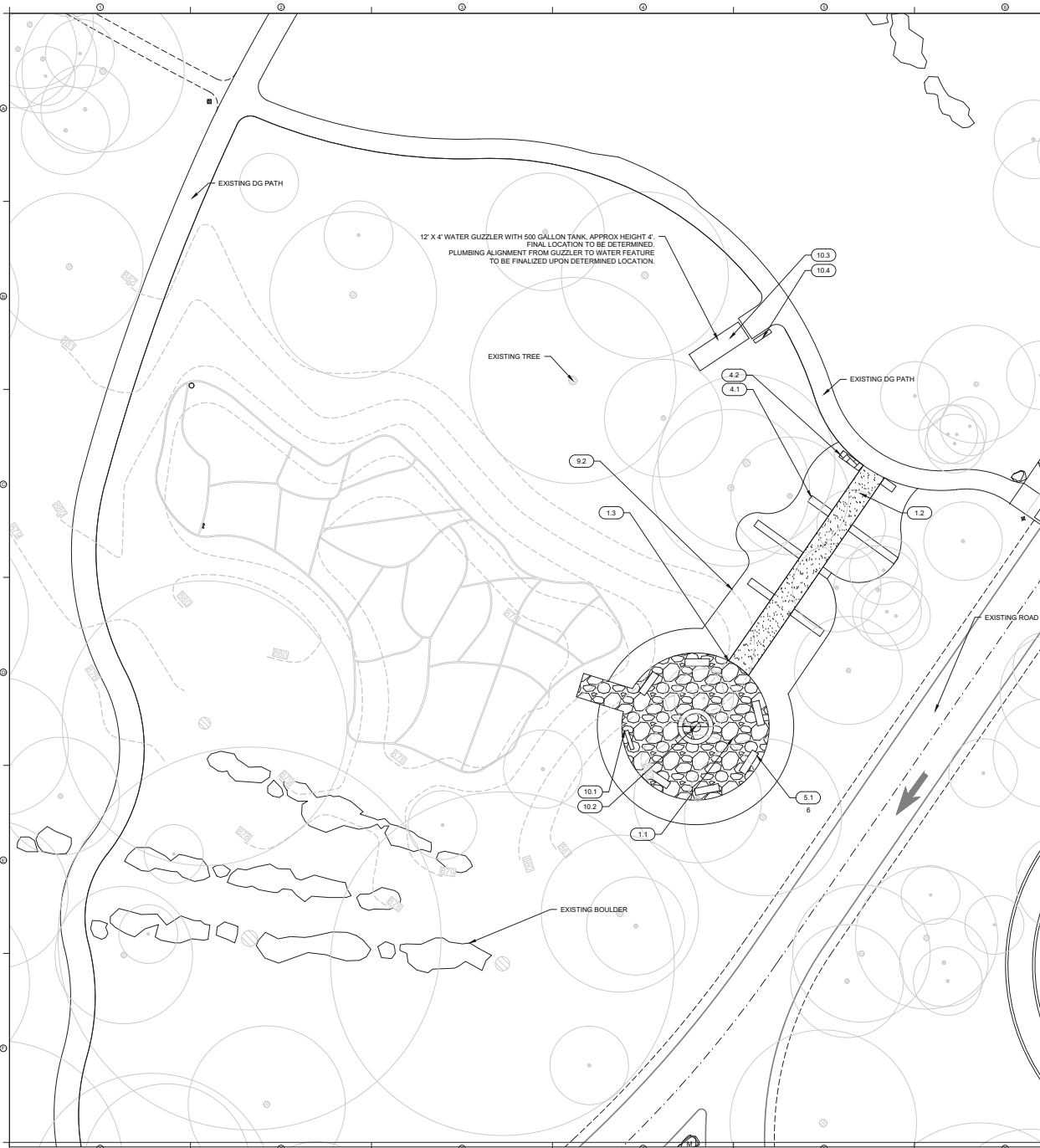

Call-Out	Item	Detail/ Sheet
<b>1 - PAVEMENT, CURBS, AND RAMPS</b>		
1.1	Stone Paver on Slab	2/L.7.01
1.2	5' DG Path with Stone Curb	1/L.7.01
1.3	DG to Stone Paver Transition	3/L.7.01
<b>4 - SITE WALLS/ EMBANKMENTS</b>		
4.1	Thematic Wall	2/L.7.02
4.2	Entry Sign	4/L.7.02
<b>5 - SITE FURNITURE</b>		
5.1	Limestone Seatwall with Wood Top	5/L.7.03
<b>9 - PLANTING AND LANDSCAPE</b>		
9.2	Steel Edging	4/L.7.03
<b>10 - MISCELLANEOUS SITE FEATURES</b>		
10.1	Commemorative Plaque	1/L.7.02
10.2	Stone Bird Bath Water Feature	1/L.7.04
10.3	Water Guzzler	3/L.7.02
10.4	Water Guzzler Interpretive Signage	1/L.7.02



**LIONHEART**

1023 Springdale Road, Suite 6E | Austin, TX 78721  
 O: 512.520.4488  
 WWW.LIONHEARTPLACES.COM

**MARILEE WOOD MEMORIAL GARDEN**

90% PERMIT SET  
 BLUE HOLE REGIONAL PARK  
 333 BLUE HOLE LN, WIMBERLEY, TX 78676

**NOT AUTHORIZED FOR CONSTRUCTION**  
 PRIOR TO FORMAL CITY APPROVAL  
 Rebecca Leonard 3038

SIGNATURE: \_\_\_\_\_  
 ISSUE DATE: \_\_\_\_\_  
 REVISIONS:

#	DATE	DESCRIPTION

DRAWN: \_\_\_\_\_ REVIEWED: \_\_\_\_\_

**SITE MATERIALS**

SHEET NUMBER  
**L3.01**

10/20/21 09:10 AM MARILEE WOOD MEMORIAL GARDEN PERMIT SET (90%) - 3038 (1) - 3038 (1) - 3038 (1)

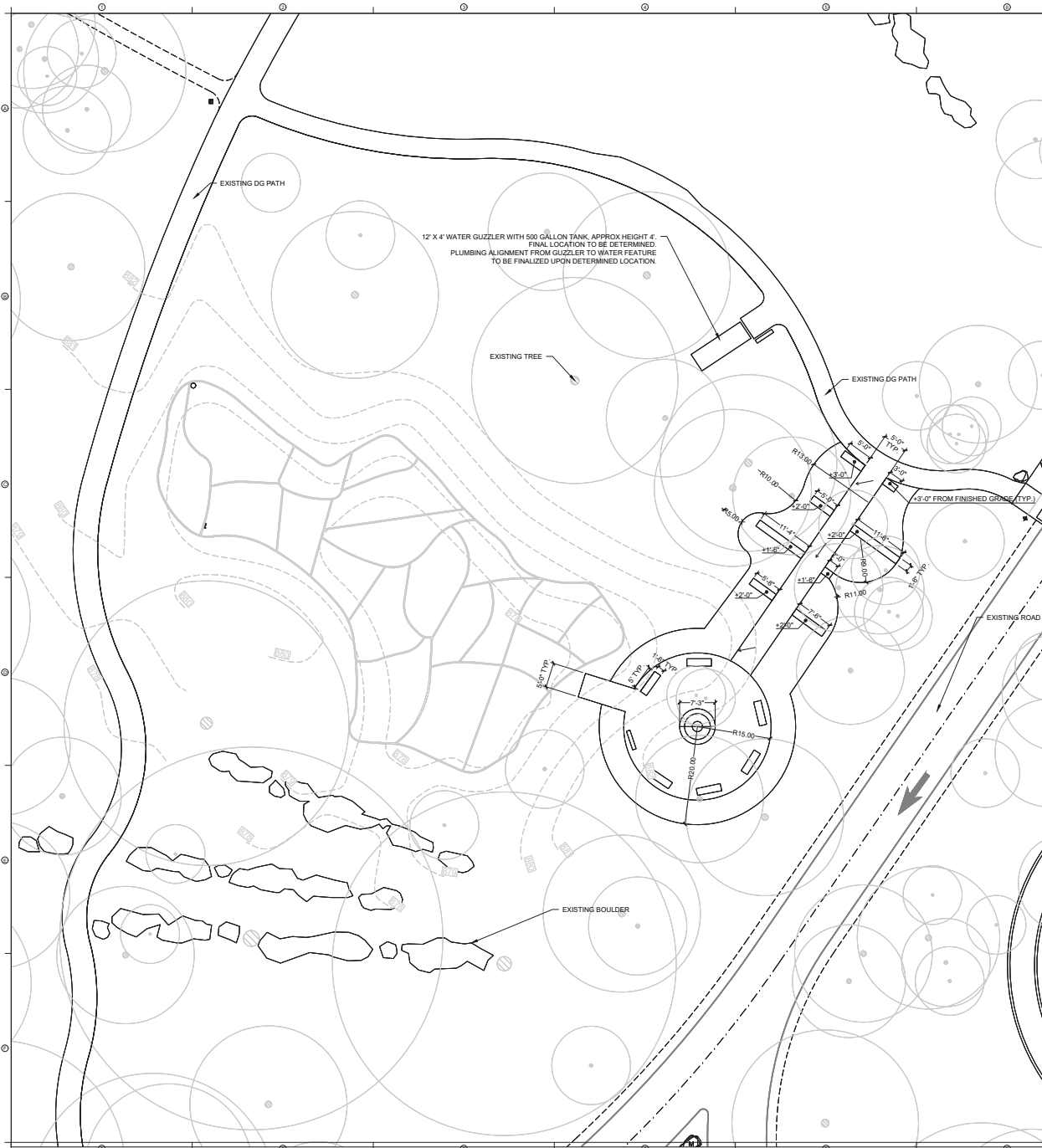

**GENERAL NOTES**

1. SLOPES IN ALL WALKING SURFACES SHALL NOT EXCEED 2% IN ANY DIRECTION.
2. TOP OF WALLS AND BENCHES SHALL BE LEVEL.



**LIONHEART**

1023 Springdale Road, Suite 6E Austin, TX 78721  
 O: 512.520.4488  
 WWW.LIONHEARTPLACES.COM

**MARILEE WOOD MEMORIAL GARDEN**

90% PERMIT SET  
 BLUE HOLE REGIONAL PARK  
 333 BLUE HOLE LN, WIMBERLEY, TX 78676

**NOT AUTHORIZED FOR CONSTRUCTION**  
 PRIOR TO FORMAL CITY APPROVAL  
 Rebecca Leonard 3038

SIGNATURE: \_\_\_\_\_

ISSUE DATE: \_\_\_\_\_

REVISIONS

#	DATE	DESCRIPTION

DRAWN: \_\_\_\_\_ REVIEWED: \_\_\_\_\_

**SITE LAYOUT PLAN**

SHEET NUMBER

L3.02



LIONHEART

1023 Springdale Road, Suite 6E | Austin, TX 78721  
O: 512.520.4488  
WWW.LIONHEARTPLACES.COM

MARILEE WOOD MEMORIAL GARDEN

90% PERMIT SET  
BLUE HOLE REGIONAL PARK  
333 BLUE HOLE LN, WIMBERLEY, TX 78676

NOT AUTHORIZED FOR CONSTRUCTION  
PRIOR TO FORMAL CITY APPROVAL  
Rebecca Leonard 3038

SIGNATURE: \_\_\_\_\_

ISSUE DATE: \_\_\_\_\_

REVISIONS

#	DATE	DESCRIPTION

DRAWN: \_\_\_\_\_ REVIEWED: \_\_\_\_\_

SITE DETAILS

SHEET NUMBER

L7.01

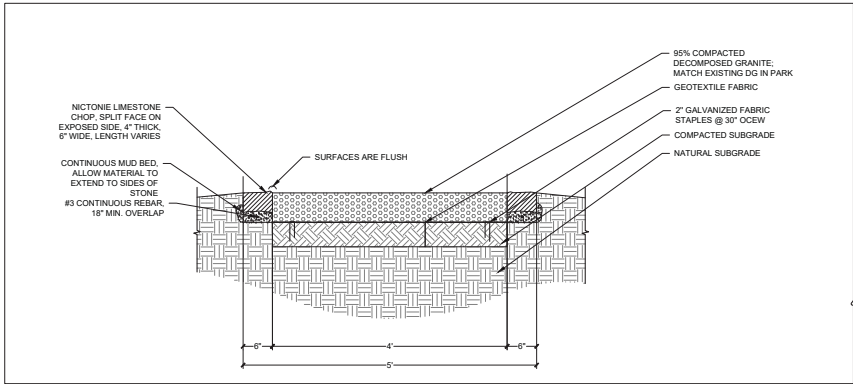

1 | 5' DG PATH WITH STONE CURB  
1" = 1'-0" SECTION

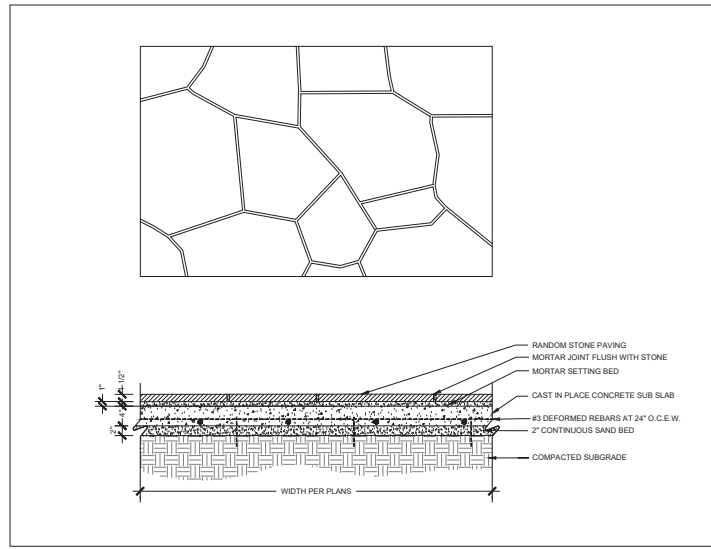

2 | STONE PAVING ON SLAB  
1" = 1'-0" SECTION

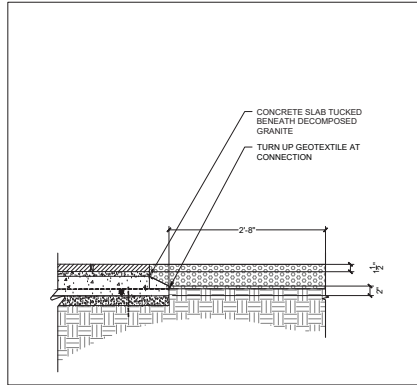

3 | DG TO STONE PAVER TRANSITION  
1" = 1'-0" SECTION

REVISED: 2/20/2024 MARILEE WOOD MEMORIAL GARDEN PERMIT SET L7.01 (30% SUBMITTAL)



**LIONHEART**

1023 Springdale Road, Suite 6E • Austin, TX 78721  
 O: 512.520.4488  
 WWW.LIONHEARTPLACES.COM

**MARILEE WOOD MEMORIAL  
 GARDEN**

90% PERMIT SET

BLUE HOLE REGIONAL PARK  
 333 BLUE HOLE LN, WIMBERLEY, TX 78676

**NOT  
 AUTHORIZED FOR  
 CONSTRUCTION**  
 PRIOR TO FORMAL CITY APPROVAL  
 Rebecca Leonard 3038

SIGNATURE: \_\_\_\_\_

ISSUE DATE: \_\_\_\_\_

REVISIONS

#	DATE	DESCRIPTION

DRAWN: \_\_\_\_\_ REVIEWED: \_\_\_\_\_

**SITE DETAILS**

SHEET NUMBER

**L7.02**

NOTE: PHOTO ONLY REPRESENTS DESIGN INTENT. FINAL WATER GUZZLER TO BE CONSTRUCTED DESIGN-BUILD.



12" X 4" WATER GUZZLER WITH 500 GALLON TANK, APPROX. HEIGHT 4'. FINAL LOCATION TO BE DETERMINED. FILING ALIGNMENT FROM GUZZLER TO WATER FEATURE TO BE FINALIZED UPON DETERMINED LOCATION.



**1 | COMMEMORATIVE PLAQUE**  
 NTS SECTION

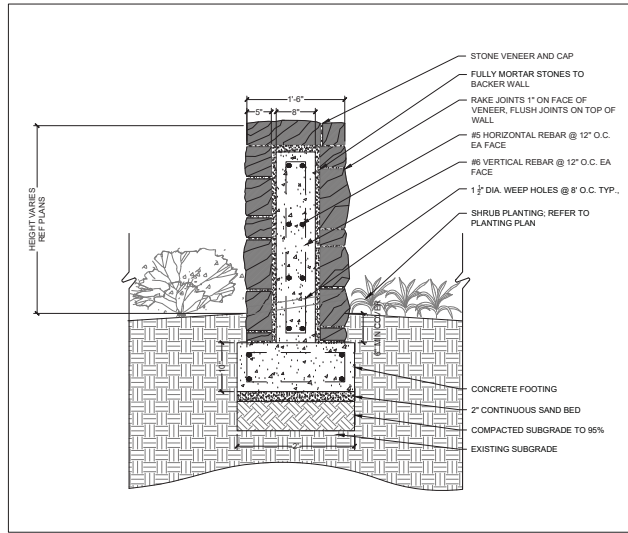

**2 | THEMATIC WALL AT SHRUB PLANTING**  
 3/4" = 1'-0" SECTION

**3 | WATER GUZZLER**  
 NTS

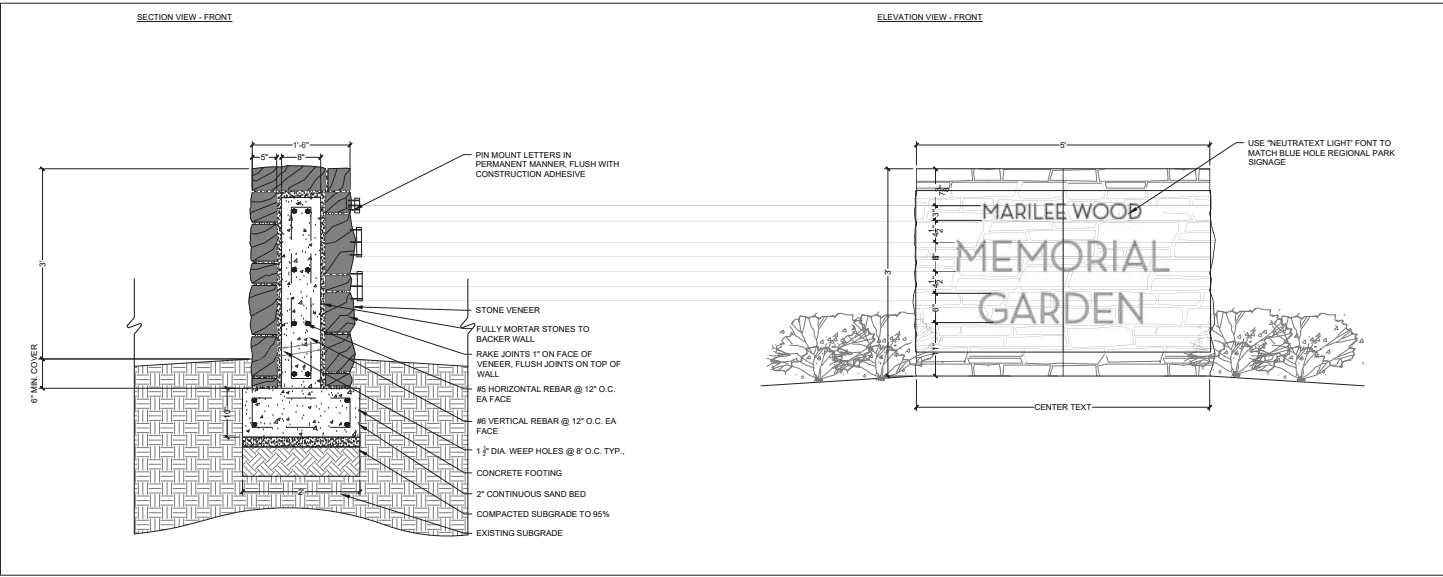

**4 | ENTRY SIGN**  
 3/4" = 1'-0" SECTION

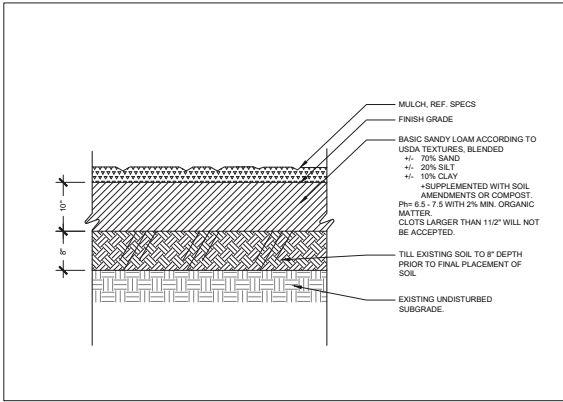

**1 | SOIL MIX-TYPE II**

1/2" = 1'-0"

SECTION

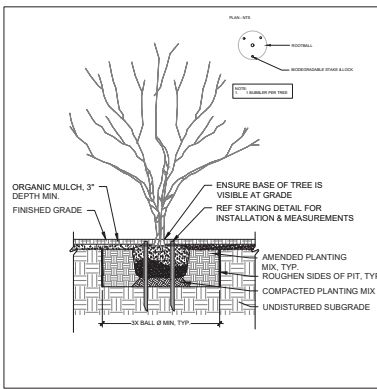

**2 | MULTI-TRUNK TREE**

1/2" = 1'-0"

SECTION

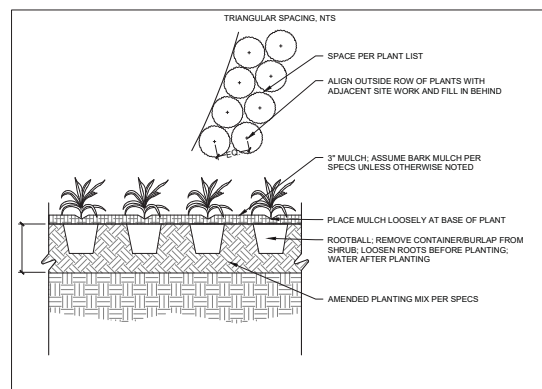

**3 | SHRUB PLANTING**

1/2" = 1'-0"

SECTION

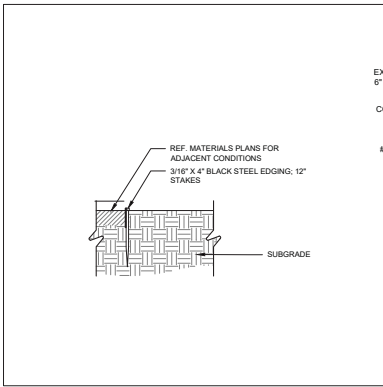

**4 | STEEL EDGING**

1" = 1'-0"

SECTION

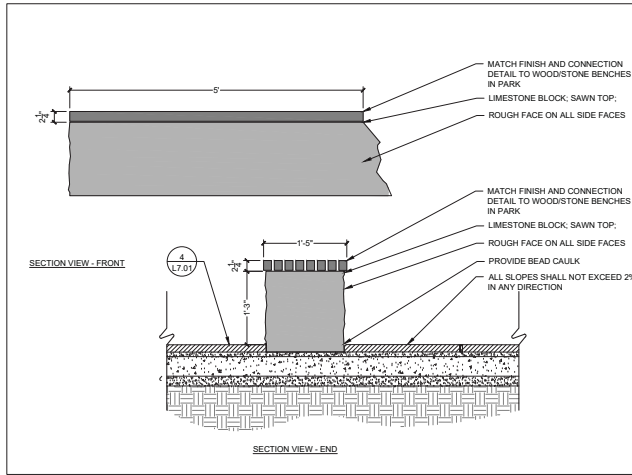

**5 | LIMESTONE SEATWALL WITH WOOD TOP**

1" = 1'-0"

SECTION



**5 | SEAT WALLS IN PARK**

NTS



**LIONHEART**

1023 Springdale Road, Suite 6E | Austin, TX 78721

O: 512.520.4488

WWW.LIONHEARTDESIGN.COM

**MARILEE WOOD MEMORIAL GARDEN**

90% PERMIT SET

BLUE HOLE REGIONAL PARK  
333 BLUE HOLE LN., WIMBERLEY, TX 78676

**NOT AUTHORIZED FOR CONSTRUCTION**  
PRIOR TO FORMAL CITY APPROVAL  
Rebecca Leonard 3038

SIGNATURE: \_\_\_\_\_

ISSUE DATE: \_\_\_\_\_

REVISIONS

#	DATE	DESCRIPTION

DRAWN: \_\_\_\_\_ REVIEWED: \_\_\_\_\_

**SITE DETAILS**

SHEET NUMBER

**L7.03**



### 30" Natural Millstone Fountain | Installation Information

If you are thinking about a Natural Millstone Fountain or are ready to install your new Natural Millstone Fountain, here at Stone Forest, we provide all the components you need for a simple, recirculating set-up. Let's take a closer look at how this works:

#### One | Natural Millstone Fountain

**Two | Accessories** - There are 3 basic components we sell individually that complete the setup:



1. **FOUNTAIN INSTALLATION RESERVOIR, 44 INCH SQUARE** this holds the water under the fountain, think of this as a hidden pool. It holds approximately 60 gallons of water. [Specification on our website.](#)



2. **SUBMERSIBLE PUMP, 528GPH** submersible pump (plugs into a 110V electrical outlet) The pump is connected to flexible hosing that pushes the water up through the fountain. We recommend the outlet be no closer to the reservoir than 4 feet. This pump is offered in 10 foot electric cord length, plan accordingly. [Specification on our website.](#)



3. **PEBBLES, Six (6) bags** of our Mexican Beach Pebbles will be required for this installation. This will cover 12 square feet. They hide the reservoir underneath for a seamless, "disappearing" effect. [See on website.](#)

**Three | Location** Find a nice spot in your yard where you'd like to showcase your snazzy new Stone Forest fountain. You'll be digging a hole into the dirt in this area, so make sure it's not a hard surface like a patio or concrete pad (unless you love jack-hammering!), or an extremely root-ridden area right next to an ancient, gnarly tree.

#### Installation Guide

First install the Fountain Installation Reservoir 44" Kit with provided installation instructions. You can also find the instructions on our website: <https://stoneforest.com/install-kit-44-inch-square>

- Once your reservoir is installed double check to make sure it is level. Put the pump in the reservoir. It's best if the pump access door is on the side nearest the power supply. Run the pump power cord out the side, under the edge of the cover. Put all covers in place.
- Place the stone fountain pedestal in the center and level it using plastic shims.
- Line up the center drill holes of the millstone and pedestal, set in place. Using plastic shims, level the fountain between the millstone and pedestal.
- Next, push the hose down, plug side up, through the drill holes. The plug should seal flush at the top of the millstone.
- Once the Natural Millstone is in place (and level) reach into the reservoir and pull the hose end to connect it to the pump. Hide or bury the pump's electric cord as necessary (as mentioned by your electrician).
- Fill your reservoir with water, plug the pump in. You may have to shim one last time between the pedestal and millstone to get full, even water coverage. Cover the reservoir with the smooth river pebbles.



VOILA! Grab a drink and lounge chair. Prepare to be relaxed by the soothing sounds of your new fountain.

213 S. La Francis Drive | Santa Fe, NM 87501 | 505.966.8883 | info@stoneforest.com | stoneforest.com

## 1 | SMALL ANTIQUE MILLSTONE WATER FEATURE TOP - INSTALLATION



### DISAPPEARING WATER FEATURE BASIN • CUVETTE POUR JEUX D'EAU EN CIRCUIT FERMÉ • CUBETA PARA FUENTE DE AGUA QUE DESAPARECE

Franklin Electric Co., Inc.  
P. O. Box 12010  
Oshkosh, WI, WI 53092-0110  
405.947.2011 • Fax: 405.948.8720  
www.LittleGiantPump.com  
CustomerService-WTS@feli.com

#### INTRODUCTION

This instruction sheet provides you with the information required to safely own and operate your Little Giant product. Retain these instructions for future reference.

The Little Giant product you have purchased is of the highest quality workmanship and material, and has been engineered to give you long and reliable service. Little Giant products are carefully tested, inspected, and packaged to ensure safe delivery and operation. Please examine your items carefully to ensure that no damage occurred during shipment. If damage has occurred, please contact the place of purchase. They will assist you in replacement or repair, if required.

**READ THESE INSTRUCTIONS CAREFULLY BEFORE ATTEMPTING TO INSTALL, OPERATE, OR SERVICE YOUR LITTLE GIANT PRODUCT. KNOW THE PRODUCT'S APPLICATION, LIMITATIONS, AND POTENTIAL HAZARDS. PROTECT YOURSELF AND OTHERS BY OBSERVING ALL SAFETY INFORMATION. FAILURE TO COMPLY WITH THESE INSTRUCTIONS COULD RESULT IN PERSONAL INJURY AND/OR PROPERTY DAMAGE!**



#### INSTALLATION (DFB44)

Refer to Figure 2 and the following instructions to install the DFB44 basin:

- Dig a hole 10" deep, 29" square at the bottom, and sloping to 37" square at the top. Ensure that the ground at the bottom is level and solid.
- Place the basin into the hole.
- Insert the 8 supports into the 8 support holes.
- Place the center plate (gray) onto the supports, pressing firmly to ensure full installation.
- Place the pump into the basin.
- Cut a length of tubing long enough to reach from the bottom of the basin to the top of the water feature.
- Run the tubing through the center hole in the top of the center plate and connect it to the pump outlet fitting.
- Install the four top plates. On the side nearest the power supply, run the pump power cord out the cord gap, under the edge of the top plate, and through the cord cut-out.
- Install the four access covers, ensuring that the cut-out in each faces outward.
- Refer to the water feature owner's manual to complete the installation.

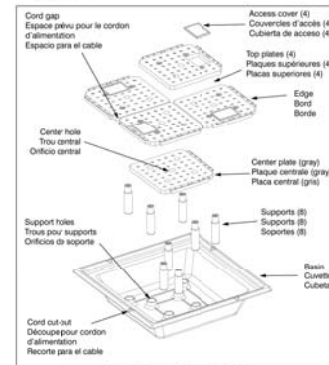

Figure 2 - Figure 2 - DFB44

## 2 | DISAPPEARING WATER FEATURE BASIN - INSTALLATION



LIONHEART

1023 Springdale Road, Suite 6E • Austin, TX 78721

O: 512.520.4488

WWW.LIONHEARTPLACES.COM

MARILEE WOOD MEMORIAL GARDEN

90% PERMIT SET

BLUE HOLE REGIONAL PARK  
333 BLUE HOLE LN, WIMBERLEY, TX 78676

NOT AUTHORIZED FOR CONSTRUCTION

PRIOR TO FORMAL CITY APPROVAL  
Rebecca Leonard 3038

SIGNATURE: \_\_\_\_\_

ISSUE DATE: \_\_\_\_\_

REVISIONS

# DATE DESCRIPTION

\_\_\_\_\_

\_\_\_\_\_

\_\_\_\_\_

\_\_\_\_\_

\_\_\_\_\_

\_\_\_\_\_

\_\_\_\_\_

\_\_\_\_\_

\_\_\_\_\_

\_\_\_\_\_

\_\_\_\_\_

\_\_\_\_\_

\_\_\_\_\_

\_\_\_\_\_

\_\_\_\_\_

\_\_\_\_\_

\_\_\_\_\_

\_\_\_\_\_

\_\_\_\_\_

\_\_\_\_\_

\_\_\_\_\_

\_\_\_\_\_

\_\_\_\_\_

\_\_\_\_\_

\_\_\_\_\_

\_\_\_\_\_

\_\_\_\_\_

\_\_\_\_\_

SITE DETAILS

SHEET NUMBER

L7.04



**LIONHEART**

1023 Springdale Road, Suite 6E Austin, TX 78721  
O: 512.520.4488  
WWW.LIONHEARTFACES.COM

MARILEE WOOD MEMORIAL  
GARDEN

90% PERMIT SET  
BLUE HOLE REGIONAL PARK  
333 BLUE HOLE LN, WIMBERLEY, TX 78676

NOT  
AUTHORIZED FOR  
CONSTRUCTION  
PRIOR TO FORMAL CITY APPROVAL  
Rebecca Leonard 3038

SIGNATURE: \_\_\_\_\_

ISSUE DATE: \_\_\_\_\_

REVISIONS

# DATE DESCRIPTION

\_\_\_\_\_

\_\_\_\_\_

\_\_\_\_\_

\_\_\_\_\_

\_\_\_\_\_

\_\_\_\_\_

\_\_\_\_\_

\_\_\_\_\_

DRAWN: \_\_\_\_\_ REVIEWED: \_\_\_\_\_

SITE DETAILS

SHEET NUMBER

L7.05

Item: WP-2000

**Submersible Recirculating Fountain Pump**



Flow rate: 528 gph

Operating Voltage: 120v  
10' POWER CORD

Overall size:  
4.2"L x 3"W x 4"H

**Warranty**

I. This pump carries a Limited Warranty for a period of 12 months from the date of original purchase by the consumer.

**II. Instructions Applicable to this Limited Warranty**

1. Consumers wishing to submit a warranty claim must return the products accompanied by this warranty to the point of purchase for warranty consideration.
2. This warranty policy does not cover any labor or shipping charges. The Company shall not be liable for any costs or charges attributable to any product testing, maintenance, installation, repair or removal, or for any tools, supplies, or equipment needed to install, repair, or remove any product.

**III. Limitations Applicable to this Limited Warranty THIS WARRANTY DOES NOT APPLY TO ANY OF THE FOLLOWING:**

1. Any product that is not installed, applied, maintained and used in accordance with the Company's published instructions, applicable codes, applicable ordinances and/or with generally accepted industry standards.
2. Any product that has been subject to misuse, misapplication, neglect, alteration, accident, abuse, tampering, acts of God (including lightning), acts of terrorism, acts of war, fire, improper storage or installation, improper use, improper maintenance or repair, damage or casualty, or to an excess of the recommended maximums as set forth in the product instructions.
3. Any product that is operated with any accessory, equipment, component, or part not specifically approved by the Company.
4. Products damaged by normal wear and tear, normal maintenance services and the parts used in connection with such service, or any other conditions beyond the control of the Company.
5. Any product that has been used for purposes other than those for which it was designed and manufactured.
6. Any use of the product where installation instructions and/or instructions for use were not followed.
7. Products connected to voltage other than indicated on nameplate.

3 WATER FEATURE PUMP  
NTS





Call-Out	Common Name	Botanical Name	Size	Quantity	Spacing
<b>1.1 - RAIN GARDEN TYPE 1</b>					
AA	Antelope-Horn Milweed	Asclepias speciosa	1 GAL	93	12"
CO	Butorbulsh	Cephalanthus occidentalis	1 GAL	14	72"
EP	Purple Coneflower	Echinacea purpurea	1 GAL	93	12"
NT	Mexican feathergrass	Nassella tenuisissima	1 GAL	94	18"
SO	Fall aster	Symphoricarpos oblongifolium	1 GAL	59	30"
<b>1.2 - RAIN GARDEN TYPE 2</b>					
AG	Burly Broomrape	Arthropogon plumosus	1 GAL	81	24"
GP	Blackflower	Gaillardia puchetta	1 GAL	110	12"
RH	Black-eyed susan	Rudbeckia hirta	1 GAL	90	18"
SL	Lindheimer's Setaria	Setaria lindheimeri	1 GAL	64	18"
SS	Little bluestem	Schizachyrium scoparium	1 GAL	78	18"
<b>1.3 - RAIN GARDEN TYPE 3</b>					
LP	Texas Blazing Star	Liatris punctata	1 GAL	76	18"
NT	Mexican leafygrass	Nassella tenuisissima	1 GAL	83	18"
RC	Lighthouse Coneflower	Rudbeckia columbifera	1 GAL	120	12"
SL	Lindheimer's Setaria	Setaria lindheimeri	1 GAL	74	18"
SS	Little bluestem	Schizachyrium scoparium	1 GAL	74	18"
<b>1.4 - RAIN GARDEN TYPE 4</b>					
AH	Shrubby bonsett	Ageratina havanensis	1 GAL	58	24"
CI	Wirecup	Callitriche involucrata	1 GAL	84	12"
CO	Butorbulsh	Cephalanthus occidentalis	1 GAL	11	72"
ML	Gulf muhly	Muhlenbergia capillaris	1 GAL	38	30"
SO	Fall aster	Symphoricarpos oblongifolium	1 GAL	33	30"
<b>5 - SHRUBS</b>					
TC	Turk's Cap	Malvastrum arboreum var. drummondii	1 GAL	22	36"
SL	Fraxinifera Sumac 'Greenleaf'	Rhus aromatica 'Greenleaf'	1 GAL	65	60"
AH	Shrubby bonsett	Ageratina havanensis	1 GAL	24	30"
SO	Fall aster	Symphoricarpos oblongifolium	1 GAL	42	36"
<b>6 - TREES</b>					
FS	Flameleaf Sumac	Rhus copallata	3" CAL	11	As Shown
TML	Texas Mountain Laurel	Sophora secundiflora	3" CAL	30	As Shown



1023 Springdale Road, Suite 6E Austin, TX 78721  
 O: 512.520.4488  
 WWW.LIONHEARTPLACES.COM

MARILEE WOOD MEMORIAL GARDEN

90% PERMIT SET  
 BLUE HOLE REGIONAL PARK  
 333 BLUE HOLE LN, WIMBERLEY, TX 78676

NOT AUTHORIZED FOR CONSTRUCTION  
 PRIOR TO FORMAL CITY APPROVAL  
 Rebecca Leonard 3038

SIGNATURE: \_\_\_\_\_

ISSUE DATE: \_\_\_\_\_

REVISIONS

#	DATE	DESCRIPTION

DRAWN: \_\_\_\_\_ REVIEWED: \_\_\_\_\_

PLANTING PLAN

SHEET NUMBER  
 L9.01

©2014 LIONHEART PLACES. ALL RIGHTS RESERVED. LIONHEART PLACES IS A TRADEMARK OF LIONHEART PLACES.